

RIDGE HT 114.25  
106.49  
106.50  
107.14  
32  
FENCE HT 112.95

2a

RIDGE HT 114.23  
106.53  
106.54  
107.18  
33a

4a

RIDGE HT 113.12  
106.55  
106.56  
107.20  
34a

6a

# DEVONPORT WAY

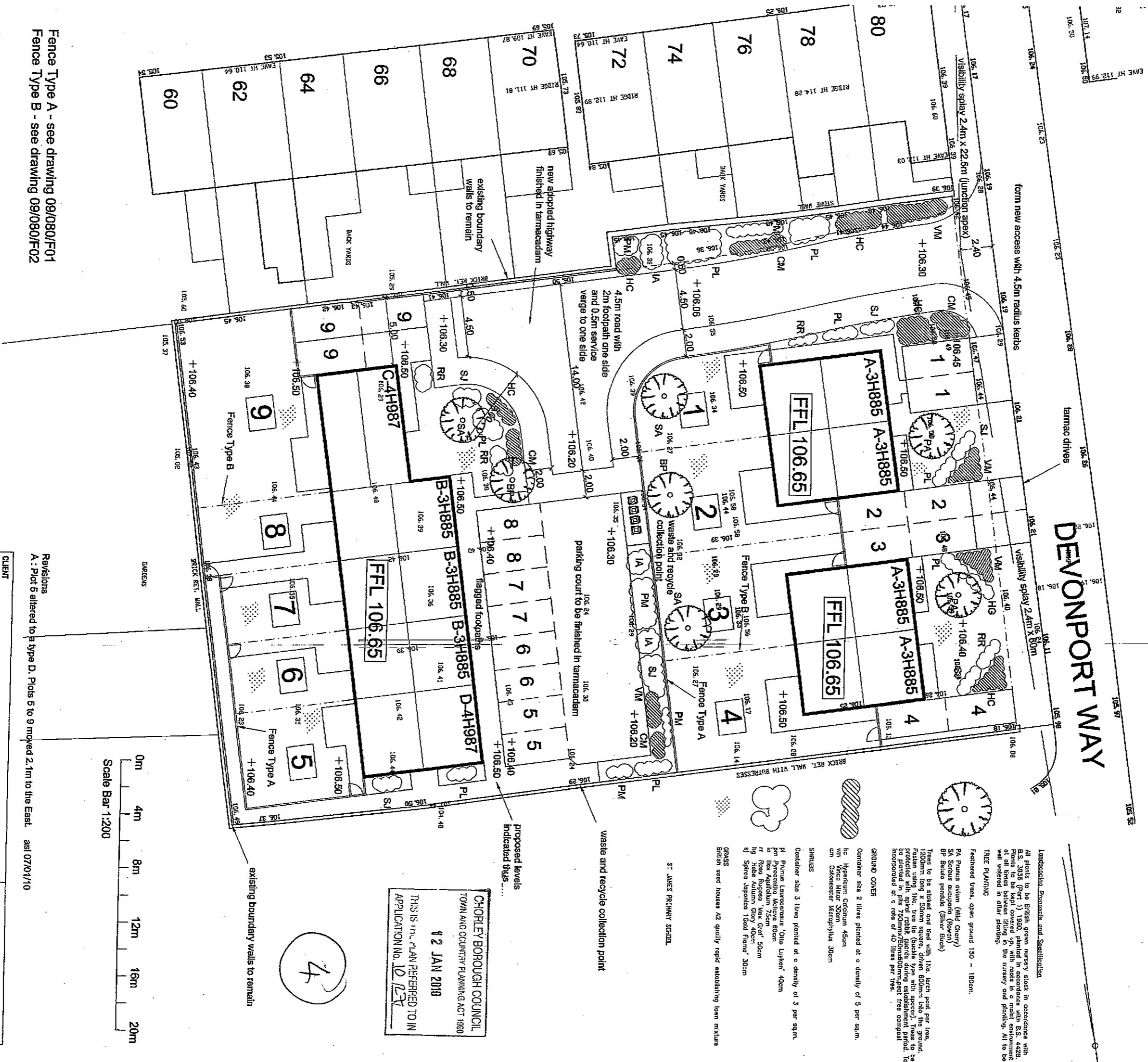

Fence Type A - see drawing 09/080/F01  
Fence Type B - see drawing 09/080/F02

Site Area = 0.23ha

Schedule Type	Reference	No.
A	3H885	4
B	3H885	3
C	4H987	1
D	4H987	1
<b>Total</b>		<b>9</b>

Revisions  
A: Plot 5 altered to a type D. Plots 5 to 9 moved 2.1m to the East. asl 07/01/10



CHORLEY BOROUGH COUNCIL  
TOWN AND COUNTRY PLANNING ACT 1990  
4 2 JAN 2010  
THIS IS THE PLAN REFERRED TO IN  
APPLICATION NO. 10 127

**Landscaping, Drainage and Specifications**  
All plants to be British green nursery stock in accordance with BS 3333 (Part 3) 1992, planted in accordance with BS 4422. Plants to be kept covered up with roots in a moist environment at all times between lifting in the nursery and planting. All to be well watered in other plantings.  
**TREE PLANTING**  
Fostered trees, open ground 150 - 180cm.  
PA Prunus avium (Wild Cherry)  
SA Sorbus aucuparia (Rowan)  
BP Betula pendula (Silver Birch)  
Trees to be staked and tied with 1No. birch post per tree. 1200mm long x 50mm square, driven 600mm into the ground. Fosters using 1No. tree tie (buckle type with secure). Trees to be secured to soil to reduce the chance of uprooting during establishment period. To be inspected and certified by a qualified tree surgeon. Tree compost incorporated at a rate of 40 litres per tree.  
**GROUND COVER**  
Container size 2 litres planted at a density of 5 per sqm.  
hc Hypericum, Cotoneaster 45cm  
vm Veronica Miller 30cm  
cm Cotoneaster Metropolitans 30cm  
**SHERBUSHES**  
Container size 3 litres planted at a density of 3 per sqm.  
pl Prunus laurocerasus 'Olio Luyken' 40cm  
pm Picea mariana 'Molitor' 60cm  
la Ilex Aquifolium 75cm  
ra Rosa rugosa 'New Gold' 50cm  
rs Rubus idaeus 'Blackberry' 40cm  
sp Spirea japonica 'Gold Flame' 30cm  
**GRASS**  
British seed houses A2 quality, rapid establishing lawn mixture

ST JAMES PRIMARY SCHOOL

waste and recycle collection point

proposed levels indicated thus

parking court to be finished in tarmacadam

existing boundary walls to remain

new adopted highway finished in tarmacadam

visibility splay 2.4m x 22.5m (junction apex)

form new access with 4.5m radius kerbs

4.5m road with 2m footpath one side and 0.5m service verges to one side

existing boundary walls to remain

new adopted highway finished in tarmacadam

flagged footpaths

4

<b>CLIENT</b> JB Loughlin (Contractors) Ltd	<b>WELMP</b> ARCHITECTURAL CONSULTANTS 213 PRESTON ROAD WINTLES-LE-WOODS CHORLEY LANCASHIRE PR6 7JG TEL: 01257 281555 FAX: 01257 281224 www.welmparchitects.co.uk
<b>PROJECT</b> Proposed Residential Development at the Former St Josephs Primary School, Devonport Way, Chorley	
<b>DRAWING TITLE</b> Proposed Site Plan	
<b>DATE</b> 30/01/09	<b>SCALE</b> 1:200@A2
<b>DRAWN</b> JAL	<b>DRWG NO.</b> 09/080/P01
<b>REV</b> A	
© Copyright Loughlin Management Practice Ltd.	